

DATASHEET

CATEGORY: APLIROD® dynamic electrode
 NAME: **APLIROD® ø54x2500mm with AT-020F clamp**
 REFERENCE: **AT-111H**

PRODUCT DESCRIPTION

ø54 x 2500 mm vertical APLIROD® dynamic electrode. Includes clamp (AT-020F) and 1 bag with 25kg of APLIFILL®.



A lack of free ions in the surrounding ground is detrimental to the correct performance of the earthing. Earthing systems using dynamic electrodes are based on the contribution of ions to the ground.

The system mainly consists of a copper electrode (APLIROD®) filled with a mixture of ionic compounds. The moisture condenser absorbs environmental moisture and dissipates it in the soil surrounding the electrode, adding free ions and gradually lowering the resistivity of the soil.

> Application



DATASHEET

| | |
|------------|---|
| Reference | AT-111H |
| Dimensions | ø54 x 2500 mm |
| Shape | vertical |
| Materials | Copper + Salts |
| Weight | 35000 g |
| Includes | AT-020F + AT-032L |
| Standards | Complies with UNE 21186, NF C 17-102, IEC 62305 |

> Diagram (mm)

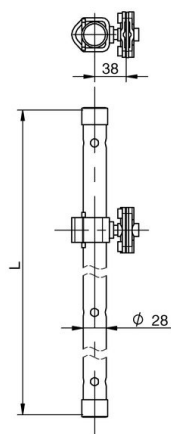

L = 2.5 m

INSTRUCTIONS

> INSTALLATION

1. Bore a 25 x 25 cm hole x 25 cm in diameter (for the earth pit), and within this another ø75 mm with an approximate depth of 10 cm less than the length of the electrode.
2. Remove the covers of the leach holes and place the electrode in the hole.
3. Fill the hole with the conductive compound APLIFILL supplied together with the electrode, mixing it with water outside the excavation and gradually fill it using 1 kilo of APLIFILL for every 4 litres of water.
4. Place the earth pit so that the cover remains at surface level. The electrode will hang out by approximately 10 cm over the bottom of the earth pit, leaving the breather holes uncovered.
5. Remove the covers of the upper breather holes and connect the grounding electrode to the test bonding bar.
6. More electrodes should be placed at regular intervals, interconnected with bare copper cable and buried at least 0.5 m deep. It is advisable to cover the conductor with APLIFILL.



OTHER INFORMATION

> ACCESSORIES



AT-032L
25kg bag APLIFILL

> RELATED PRODUCTS



AT-010H
250x250x250mm
polypropylene earth pit

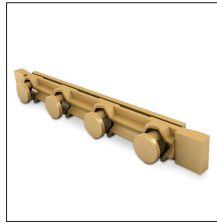

AT-020H
235x40x25mm bonding
bar for earth pit